

Detail A:
Depicts closure & temporary one way system on Saltisford.

SCALE - 1:1250

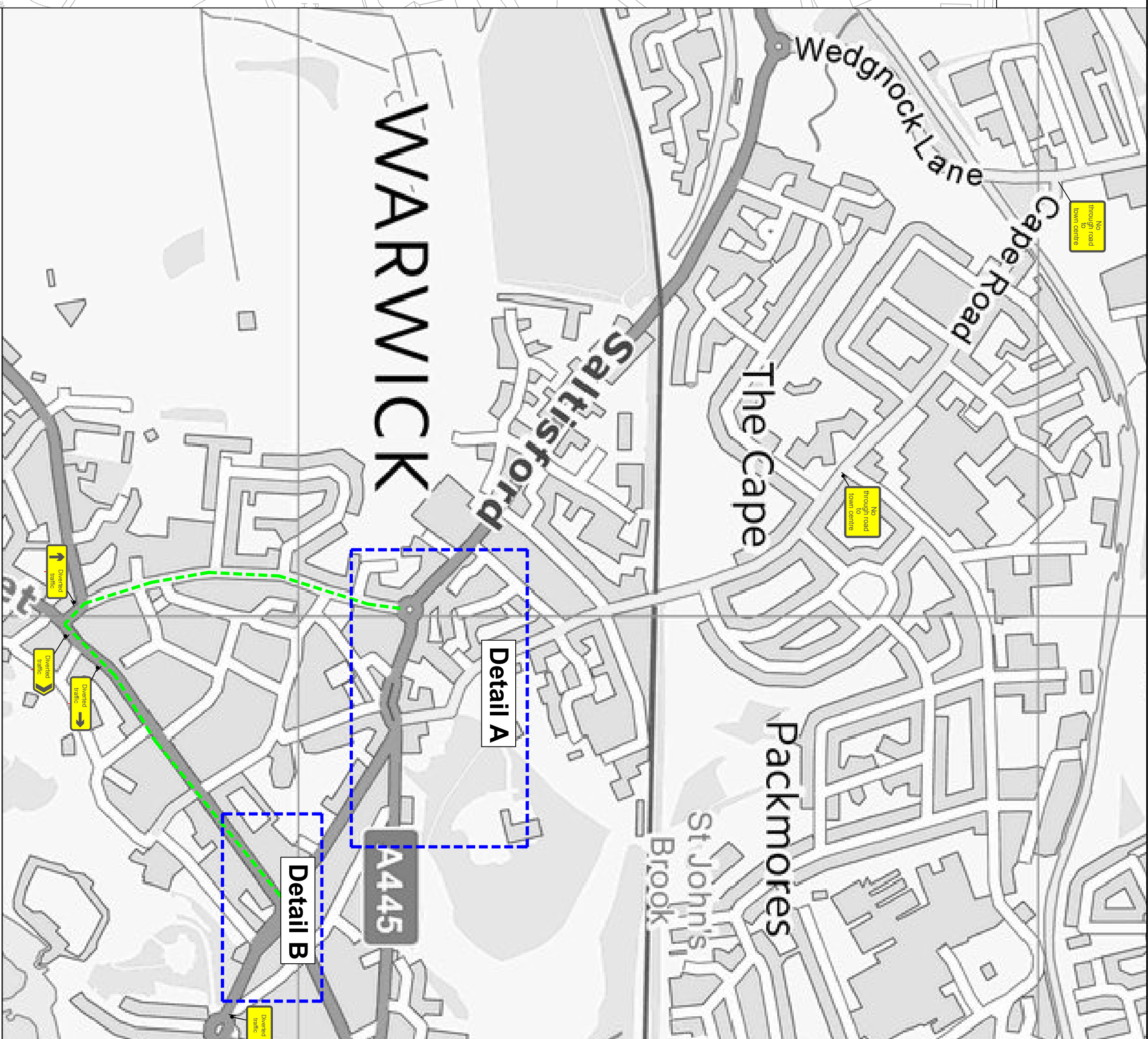
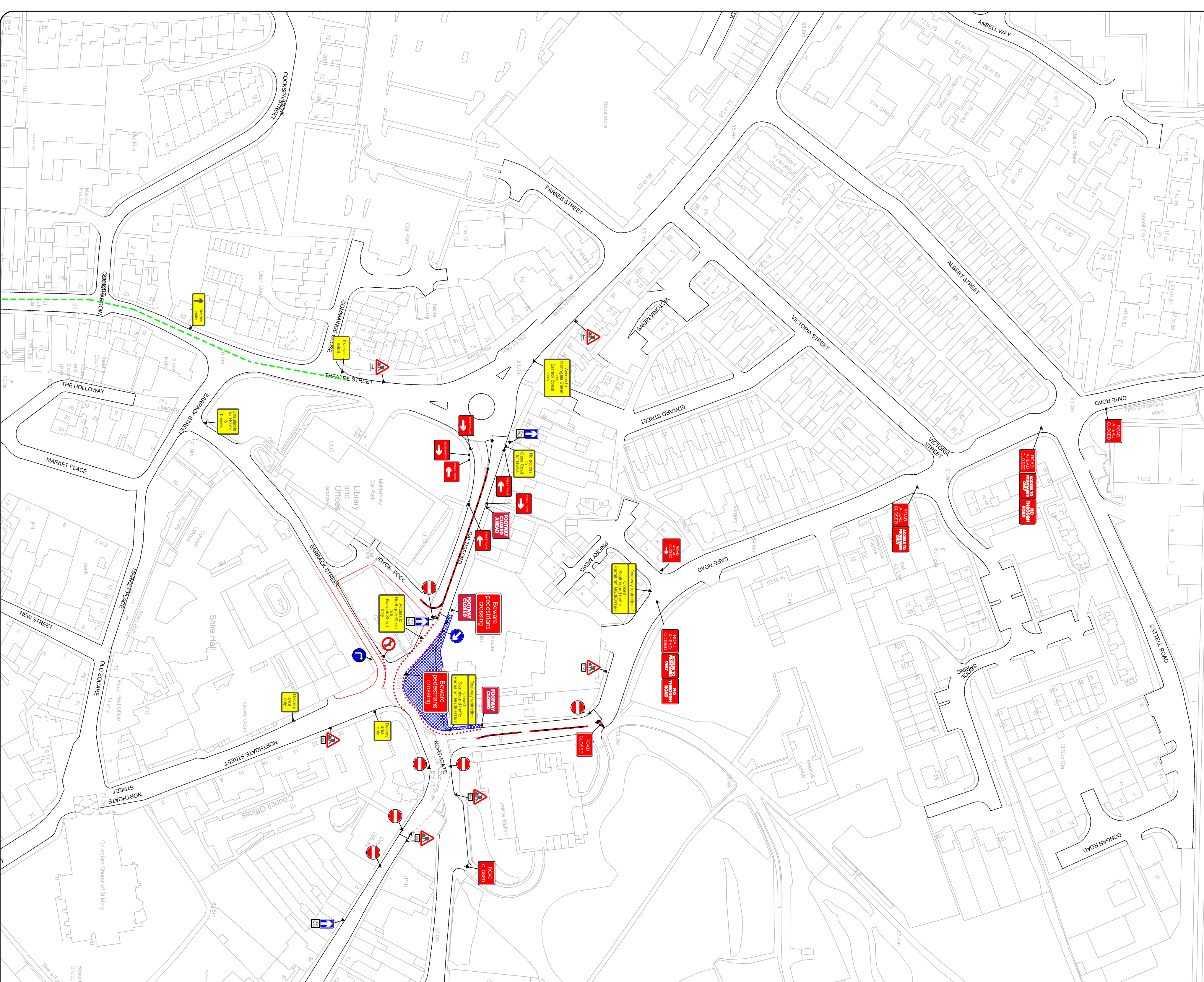

Detail B:
Depicts closure & approach to temporary one way system on A425 The Butts.

SCALE - 1:750

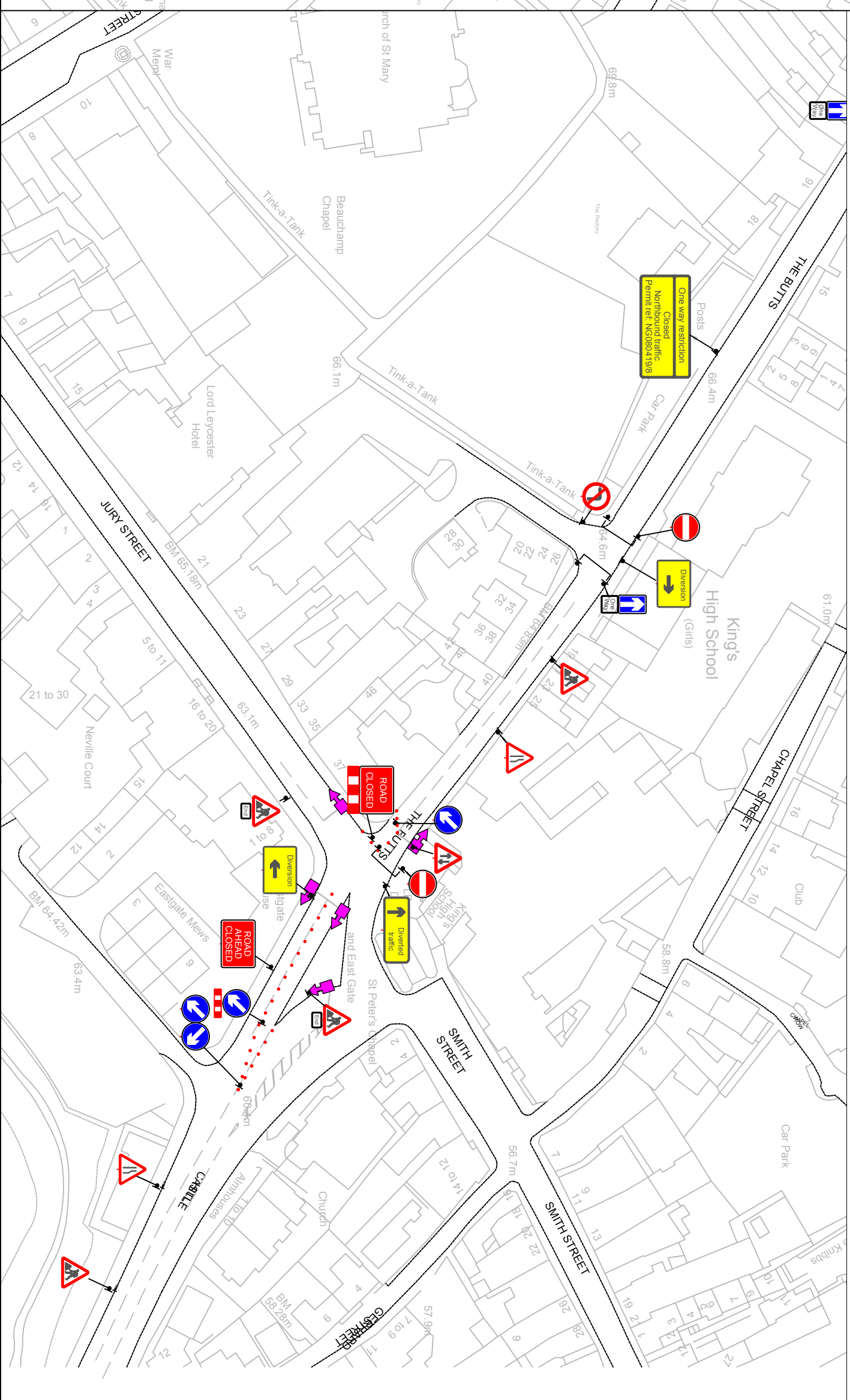

Key:	
	Line of Works
	Works Area
	Road Closure
	Diversion Route
	Cone
	Prohibition Banner
	Temporary Sign
	Temporary Traffic Signal
	Stop & Go Board
	Permanent Traffic Signal
	Temporary Ped Signal
	Exiting Bus Stop
	3.5t Van

Notes:	
Min width of sideways safety zone (S)	0.5m
Min length of longways clearance (L)	0.5m
The Butts	30
Salford	30

Balfour Beatty

Living Places

Working in Partnership with

traffix®

bold, traffic & event management solutions

Old Aston Reservoirs, Blackwell, Solihull, West Midlands, B36 0DY
t +44 (0)1600 819 9011 / f +44 (0)1615 425207
info@traffixuk.com / www.traffixuk.com

Project Title	Traffic Management			
Phase 2				
Drawings title	Proposed Road Closure & One Way System			
	The Bulins			
	Warwick			
	C/3/4 4RL			
Drawn	04/07/2019	Scale	See DWG	Paper
Checked		CM		A1
MO		CM		Approved
Project Number	TFX MTT1082	Drawn Number	203	MT
				Revision
				-

This drawing is copyright & the property of Traffic & must not be copied in whole or in part without their written permission. Copyright is reserved. © This drawing must not be scaled.
The Contractor is to report all discrepancies & errors to the Contract Manager prior to works commencing.