

NOTICE OF CONFIRMATION OF AN ORDER

HIGHWAYS ACT 1980

WARWICKSHIRE COUNTY COUNCIL

M282 FILLONGLEY PUBLIC PATH DIVERSION ORDER 2017

On 17 April 2018 Warwickshire County Council confirmed the above Order made under Section 119 of the Highways Act 1980.

The effect of the Order as confirmed will **DIVERT** M282 from Point A (grid reference 42528 28569) running generally east north east for approximately 623 metres to Point X on Green End Lane (grid reference 42580 28602) **TO A LINE** commencing at Point A (grid reference 42528 28569) the path runs generally north east, firstly along a fence line for approximately 24 metres, then curving through a clearing at the edge of a wooded area before running along the vegetated edge of field to a gap at Point B (grid reference 42552 28587). It then runs generally north along the edge of a wooded area to Point C (grid reference 42552 28595), then north east, to and around a pond, and alongside a fence line to Point D (grid reference 42565 28606) and continuing alongside the fence south east to Point E (grid reference 42569 28601) and north east to Green End Lane at Point Y (grid reference 42574 28607), as shown on the Order Plan, a total distance of approximately 715 metres. The new path will have a width of 2 metres.

A copy of the Order and the Order Plan have been placed and may be seen free of charge at the offices of Warwickshire County Council, Shire Hall, Market Square, Warwick CV34 4SA from 8am - 5.30pm on weekdays, (5pm Fridays) and 9am - 4pm Saturdays. A copy of the Order and Order Plan may be bought there at the price of £5.77. Copies may also be inspected at the offices of the North Warwickshire Borough Council, The Council House, South Street, Atherstone, CV9 1DE between 8.30am and 17.15pm (17.00pm Friday) and online at www.warwickshire.gov.uk/pathorders.

The Order comes into force on 24 April 2018, but if a person aggrieved by the order wants to question its validity, or that of any provision contained in it, on the ground that any requirement of the Act, as amended, or if any regulation made under the Act has not been complied with in relation to the order, he or she may, under paragraph 2 of Schedule 2 to the Act as applied by paragraph 5 of Schedule 6 to the Act, within 6 weeks from 19 April 2018, make an application to the High Court.

Dated 17 April 2018

Sarah Duxbury
Head of Law and Governance
Shire Hall, Warwick

PUBLIC PATH DIVERSION ORDER

HIGHWAYS ACT 1980

WARWICKSHIRE COUNTY COUNCIL

(PART OF FOOTPATH M282 FILLONGLEY) PUBLIC PATH DIVERSION ORDER 2017

This Order is made by Warwickshire County Council ("the authority") under section 119 of the Highways Act 1980 ("the 1980 Act") because it appears to the authority that in the interests of the owner of the land crossed by the footpath described in paragraph 1 of this Order it is expedient that the line of the path should be diverted.

Mr J Prowse, Green End Farm, Fillongley has agreed to defray any compensation which becomes payable in consequence of the coming into force of this Order and any expenses which are incurred in bringing the new site of the path into a fit condition for use by the public.

North Warwickshire Borough Council has been consulted as required by section 120(2) of the 1980 Act;

BY THIS ORDER:

1. The public right of way over the land situate at **Fillongley** and shown by a bold continuous line on the plan numbered P2009/018G contained in this Order ('the Order Plan') and described in Part 1 of the Schedule to this Order shall be stopped up after 7 days from the date of confirmation of this Order.
2. There shall at the end of 7 days from the date of confirmation of this Order be a public footpath over the land situate at **Fillongley** described in Part 2 of the Schedule and shown by a bold broken line on the Order Plan.
3. The rights conferred on the public under this Order shall be subject to the limitations and conditions set out in Part 3 of the Schedule.

SCHEDULE

PART 1

DESCRIPTION OF SITE OF EXISTING PATH OR WAY Between Points A and X on the Order Plan

Public Footpath M282 from Point A (grid reference 42528 28569) running generally east north east for approximately 623 metres to Point X on Green End Lane (grid reference 42580 28602) as shown on the Order Plan.

PART 2
DESCRIPTION OF SITE OF NEW PATH OR WAY
Between Points A, B, C, D, E and Y on the Order Plan

Commencing at Point A (grid reference 42528 28569) the path runs generally north east, firstly along a fence line for approximately 24 metres, then curving through a clearing at the edge of a wooded area before running along the vegetated edge of field to a gap at Point B (grid reference 42552 28587). It then runs generally north along the edge of a wooded area to Point C (grid reference 42552 28595), then north east, to and around a pond, and alongside a fence line to Point D (grid reference 42565 28606) and continuing alongside the fence south east to Point E (grid reference 42569 28601) and north east to Green End Lane at Point Y (grid reference 42574 28607), as shown on the Order Plan, a total distance of approximately 715 metres.

The new path will have a width of 2 metres.

PART 3
LIMITATIONS AND CONDITIONS

Gate to British Standard 5709:2006 at Points C(i), (i) and Y(i) on the Order Plan; and a 1 metre gap at Point B.

GIVEN under the Seal of the Council this 7th day of June 2017

The COMMON SEAL of the
Warwickshire County Council
was hereunto affixed in
the presence of:-

)
)
)
)

Designated Officer.

M. A. F. H. D.



746/17

The Warwickshire County Council in pursuance to their powers under Section 119 of the Highways Act 1980 hereby confirm the Order as an unopposed Order.

GIVEN under seal of the County Council this 17th day of April 2018

The COMMON SEAL of the Warwickshire County Council was hereunto affixed in the presence of :-

Designated Officer.

H. J. Howard



439/18

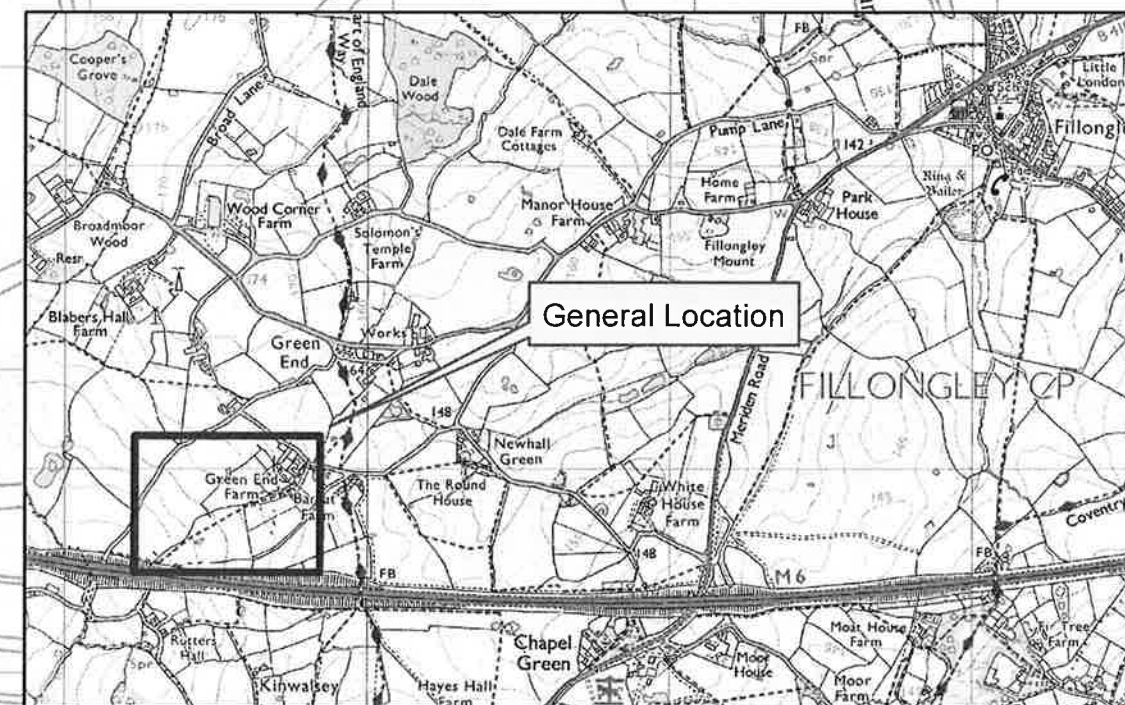
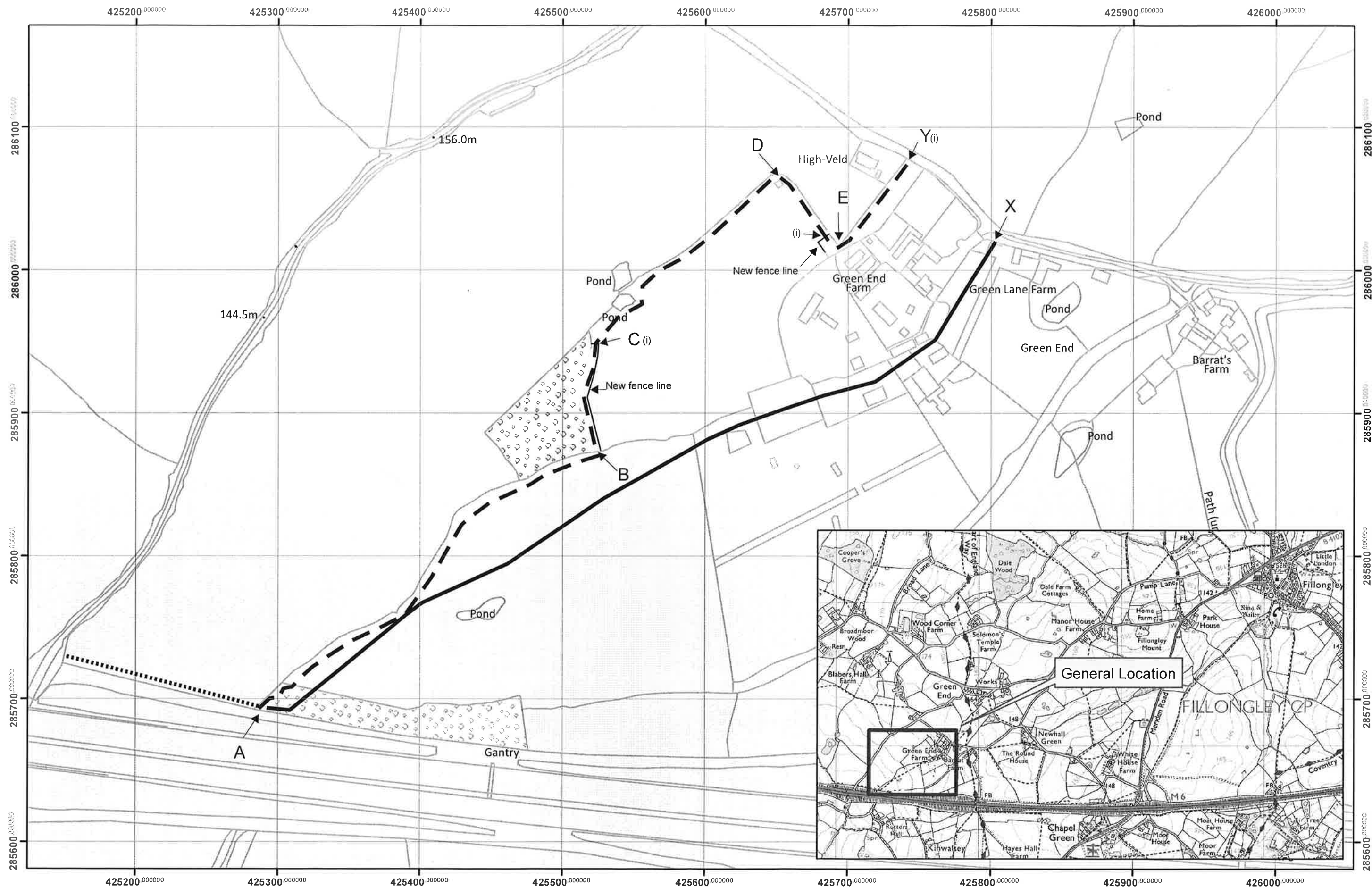

Proposed diversion of Public Footpath M282 (part) in the Parish of Fillongley (2017)
Highways Act 1980, Section 119

Order Plan (ref: P2009/018G)

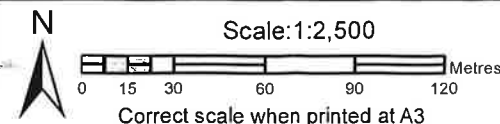

Key	
	Existing path to be diverted. Points A-X. Approx 623 metres
	Proposed diversion. Points A-B-C-D-E-Y. Approx 715 metres
	Existing path unaffected. (i) = gate, pedestrian or kissing

DATED 7 June 2017

HIGHWAYS ACT 1980

WARWICKSHIRE COUNTY COUNCIL

DUPLICATE

THE WARWICKSHIRE COUNTY COUNCIL
(PART OF FOOTPATH M282 FILLONGLEY)
PUBLIC PATH DIVERSION ORDER 2017