



Wildlife & Countryside Act 1981  
Definitive Map and Statement of Public Rights of  
Way for Warwickshire

form  
**1**

**Application for a Modification Order**

Rights of Way, Communities,  
PO Box 43, Shire Hall,  
Warwick, CV34 4SX

To: **Warwickshire County Council**

Of: **PO Box 43, Shire Hall, Warwick, CV34 4SX**

I/We: **JOHN STUART KEIGLEY**

Of: **THE HAVEN LUDINGTON STRATFORD UPON AVON  
CV37 9SD**

hereby apply for an Order under Section 53(2) of the Wildlife and Countryside Act 1981  
modifying the Definitive Map and Statement for the County of Warwick by

**Deleting** \* the Footpath / Bridleway / ~~Restricted Byway~~ / Byway Open to all Traffic \*

from ~~.....~~ to ~~.....~~

**Adding** \* the Footpath / Bridleway / ~~Restricted Byway~~ / Byway Open to all Traffic \*

from SP 168 527 to SP 168 528

**Upgrading / Downgrading** \* to a Footpath / Bridleway / ~~Restricted Byway~~ / Byway Open to all  
Traffic \* the Footpath / Bridleway / ~~Restricted Byway~~ / Byway Open to all Traffic \*

from ~~.....~~ to ~~.....~~

**Varying / Adding to** \* the particulars relating to the Footpath / Bridleway / ~~Restricted Byway~~ /  
Byway Open to all Traffic \*

from ~~.....~~ to ~~.....~~

by providing that .....

*\* delete as appropriate*

and shown on the map accompanying this application.

I/We attach copies of the following documentary evidence (including statements of witnesses)  
in support of this application (see overleaf \*\*).

Signed [Signature], Dated 21<sup>st</sup> Feb 2024

The accompanying map must be at a scale of 1:25000 or greater (e.g. 1:10000)

**Please see overleaf**

**\*\* Evidence in support of your claim -**

**Documents** 5 (number of pages attached)

Please attach a copy of any documents or maps you are using as evidence. Include the document reference number and title and give the full name and address of the Library, Record Office, University or person in possession of the original document.

**Photographs** 14 (number attached) *SEE JSKEIGHLEY USER EVIDANCE*

These should be securely mounted on card, stout paper or in plastic wallets, each should be clearly numbered and labelled with the date and place it was taken and if possible please show the location of the photograph on a plan.

**Witness Statement Forms (Form 4)** 5 (number attached)

Please number each form and make a list with the name and number of each person who has completed a "witness statement" in support of your application, on *this* form.

**List your evidence and references** (continue on a separate sheet if necessary)

1. ORDNANCE SURVEY MAP SP1652/SP1752 REVISED MAY 1965
2. WARWICKSHIRE COUNTY COUNCIL DEFINITIVE MAP 1998  
SHEET NO SP 15 SE
3. THE COUNTRYSIDE AGENCY CONCLUSIVE MAP OF REGISTERED  
COMMON LAND AND OPEN COUNTRY MAPPING AREA 7  
LUDDINGTON CP. 2005
4. STRATFORD - ON - AVON DISTRICT COUNCIL LUDDINGTON  
CONSERVATION AREA APRIL 1991.

(ALL DOCUMENTS IN POSSESSION OF J.S. KEIGHLEY)

**List your witnesses** (continue on a separate sheet if necessary)

1. JOHN STUART KEIGHLEY.
2. BRIAN WALLIS.
3. DAVID LAURENCE HIGGINS.
4. ALISON HEGARTY
5. KEVIN JOHN HEGARTY



Wildlife & Countryside Act 1981  
Definitive Map and Statement of Public Rights of  
Way for Warwickshire

form  
**1a**

**Application for a Modification Order  
(Supplementary Information)**

Rights of Way, Communities,  
PO Box 43, Shire Hall,  
Warwick, CV34 4SX

Name: JOHN STUART KEIGHLEY  
Address: THE HAVEN LUDINGTON STRATFORD UPON AVON  
CV37 9SD.

The purpose of this form is to gain as much information about the route claimed as possible.  
Please complete the following sections in as much detail as you can.

**1. Please explain why you believe the Definitive Map and Statement should be modified, for example, why you believe the route should be added to the map or should be upgraded.**

TO THE BEST OF LOCAL KNOWLEDGE FOR AT  
LEAST 50 YEARS THE PATH THROUGH  
THE MEADOW WALKING NORTH OF  
LUDINGTON VILLAGE GREEN HAS BEEN  
THE MARKED AND ACCEPTED PUBLIC  
RIGHT OF WAY.

THE PATH SHOWN ON THE DEFINITE  
MAP HAS NOT BEEN IN USE FOR  
THE LAST 50 OR SO YEARS SINCE  
THE POND WAS EXCAVATED.

2. Please describe the route carefully:

- i) Start point WOODEN KISSING GATE AT REAR OF WOODINGTON VILLAGE GREEN Grid Reference SP 168 527
- ii) End point METAL KISSING GATE AT NW CORNER OF FIELD 8477 Grid Reference SP 168 528

iii) Are there any gates / stiles / bridges? Please describe where (it would be helpful to mark them on a map).

YES MARKED AT (A) AND (B)

iv) Can the route be used today? YES

If not:

- what prevents access along the route – please mark the locations on a map.

- are you aware of when any obstruction occurred?

v) Are there any signs / notices on the route?

If yes:

- please mark their location on a map. ATTACHED

- in what year did the notices appear? NEW NOTICES APPEARED

- what do they say? IN 2023

PLEASE STAY ON THE FOOTPATH. (PHOTO 10)  
PLEASE CLEAN UP AFTER YOUR DOG (PHOTO 2)  
WAYMARKER SIGNS

vi) What is the surface type of the route? It would be helpful to mark it on a map.

GRASS.

Signed:



Dated:

21<sup>st</sup> Feb 2024

# PHOTOGRAPHS

NORTH  
↑

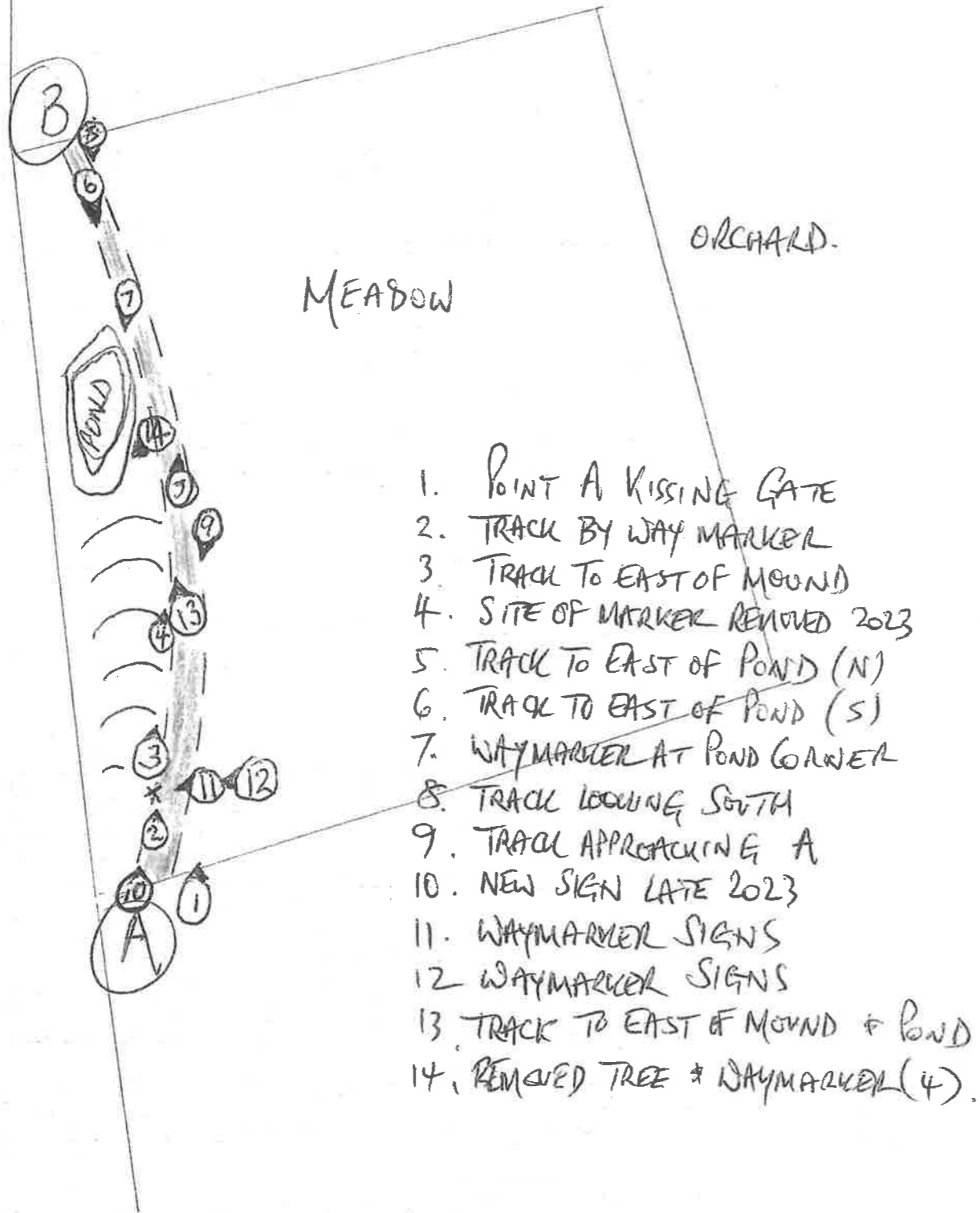

1. POINT A KISSING GATE
2. TRACK BY WAY MARKER
3. TRACK TO EAST OF MOUND
4. SITE OF MARKER REMOVED 2023
5. TRACK TO EAST OF POND (N)
6. TRACK TO EAST OF POND (S)
7. WAYMARKER AT POND CORNER
8. TRACK LOOKING SOUTH
9. TRACK APPROACHING A
10. NEW SIGN LATE 2023
11. WAYMARKER SIGNS
12. WAYMARKER SIGNS
13. TRACK TO EAST OF MOUND & POND
14. REMOVED TREE \* WAYMARKER (4).

*[Signature]*  
1<sup>st</sup> FEB 2024



# ORDNANCE SURVEY

PLAN SP 1652 & PLAN SP 1752

May 1965

Scale: 1:2500 or 25.344 inches to 1 mile

DOCUMENT 1

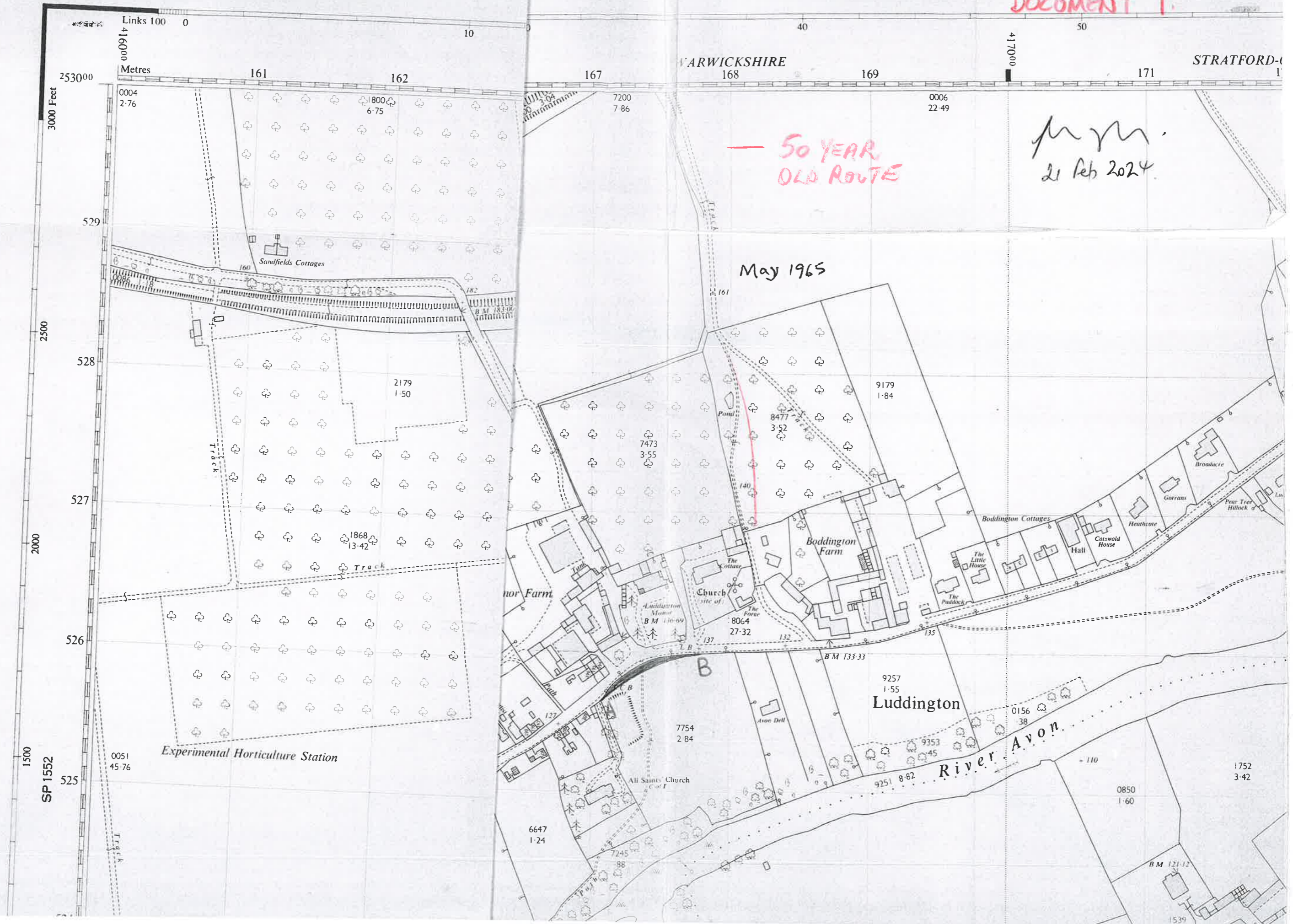

— 50 YEAR OLD ROUTE

*Handwritten signature*  
21 Feb 2024

May 1965

SP 1552

3000 Feet

2500

2000

1500

253000

529

528

527

526

525

Links 100 0

Metres

161

162

167

WARWICKSHIRE

168

169

171

STRATFORD-ON-AVON

0004  
2.76

1800  
6.75

7200  
7.86

0006  
22.49

Sandfields Cottages

Track

Track

Experimental Horticulture Station

nor Farm

Church

Boddington Farm

Boddington Cottages

Hall

Coswold House

Luddington

River Avon

All Saints Church

0051  
45.76

1868  
13.42

2179  
1.50

7473  
3.55

8477  
3.52

8064  
27.32

9257  
1.55

0156  
38

0850  
1.60

1752  
3.42

6647  
1.24

7245  
88

B.M. 121.12

1539