

If this drawing has been printed or converted to pdf format it may no longer be at true scale. It is the recipient's responsibility to confirm its accuracy before use.

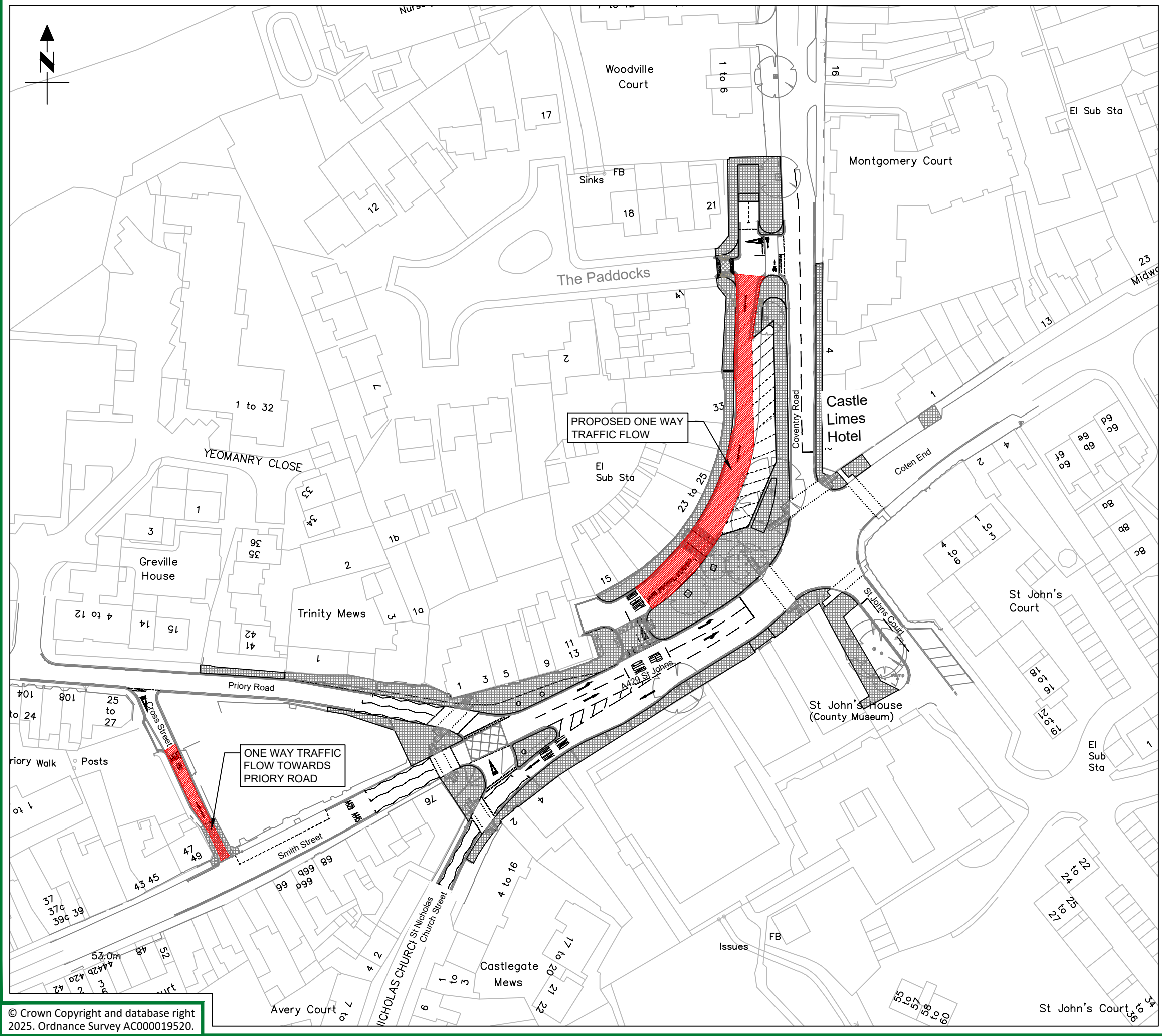

© Crown Copyright and database right 2025. Ordnance Survey AC000019520.

KEY:

ONE WAY EXTENTS

PROJECT PHASE STATUS: **PROCUREMENT**

Drawing Content Status:
COMPLETE SOLUTION

Suitable For:
TECHNICAL APPROVAL (D & C), PACKAGE ORDER (POCOC) TENDERS, TASK ORDER QUOTATIONS

PROJECT PROGRESS:

**Warwickshire
County Council**

**ENGINEERING
DESIGN SERVICES**

Engineering Design Services
Highways
Communities Directorate
Shire Hall
Warwick
CV34 4RL
Tel : 01926 410410
Web : www.warwickshire.gov.uk

FS 26655

15/09/2025 11:27:27, aaka1, ISO full bleed A3 (420.00 x 297.00 MM)

PROJECT

A429 St Johns - Warwick Town Centre
Public Realm Scheme

TITLE

Traffic Regulation Order
One Way

SCALE	SIZE
N.T.S	A3

ORIGINAL BY AA	REVISION BY N/A	REVIEWER CL	
DATE 12/09/2025	DATE N/A	APPROVER AF	

PROJECT	ORIGINATOR	VOL./SERIES	LOCATION
9.2.A429.068	- WCC	- GEN	- ZZ
DR	- CH	- 2000	- 00
TYPE	ROLE	NUMBER	REVISION

Frame V4.3.3