

- KEY:-**
- Existing unacceptable material to be removed to a depth of 225mm (footpath)
Total = 16m² or 4m².
 - Proposed footpath construction to be 225mm in depth.
Wearing course - 25mm.
Binder course - 50mm.
Sub-base - 150mm.
Total area = 16m² or 4m².
 - Proposed speed cushions (Refer to detail C006)
Total = 22 Cushions.
 - Proposed Speed Hump
Total = 1.
 - Existing speed cushions removed and carriageway to a depth of 100mm.
Total area = 18m² or 2m².
 - Proposed 100mm Inlay carriageway reinstatement.
Total Area = 18m² or 2m².
 - Proposed buff tactile paving slabs.
Total = 4m².
 - Proposed Glasdon Manchester bollards with red/white retroreflective banding on all.
Total = 4 posts.
 - Proposed signs, posts & patches
Signs - 8.
Posts - 14.
Patches - 6.
 - Proposed gully's for raised hump
Total = 2 gully's
 - Existing lighting columns.
 - Existing sign posts.

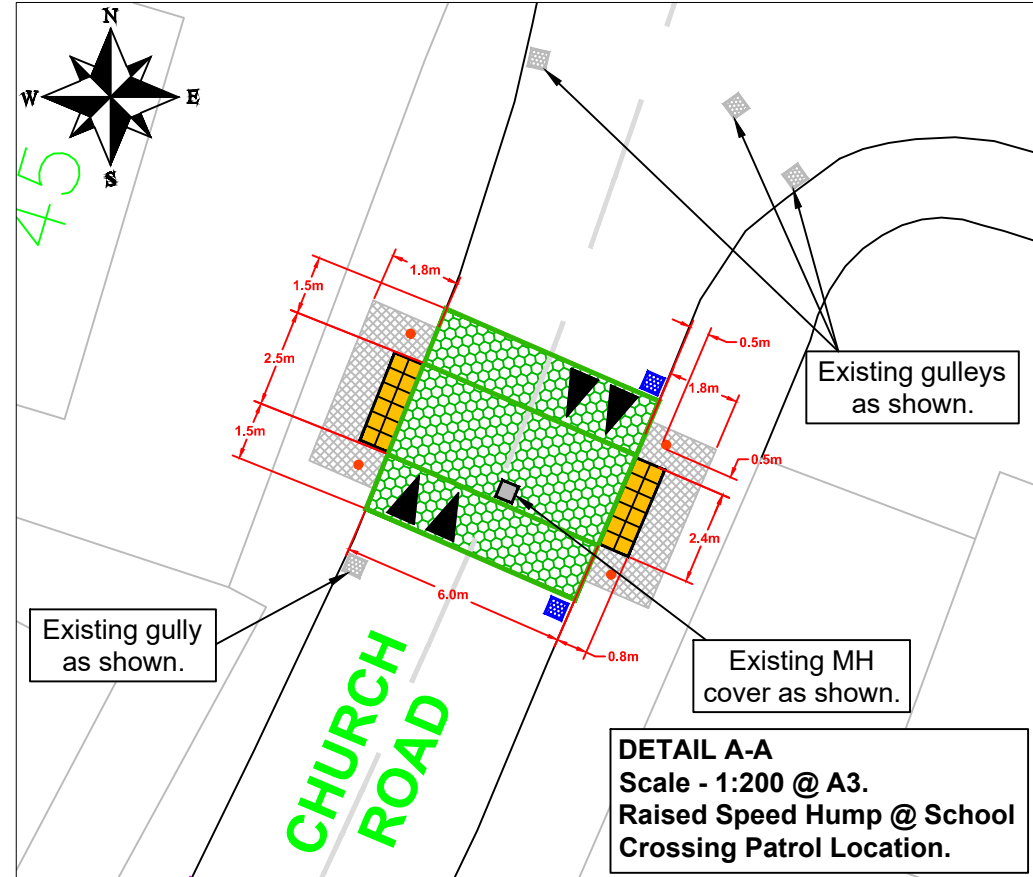
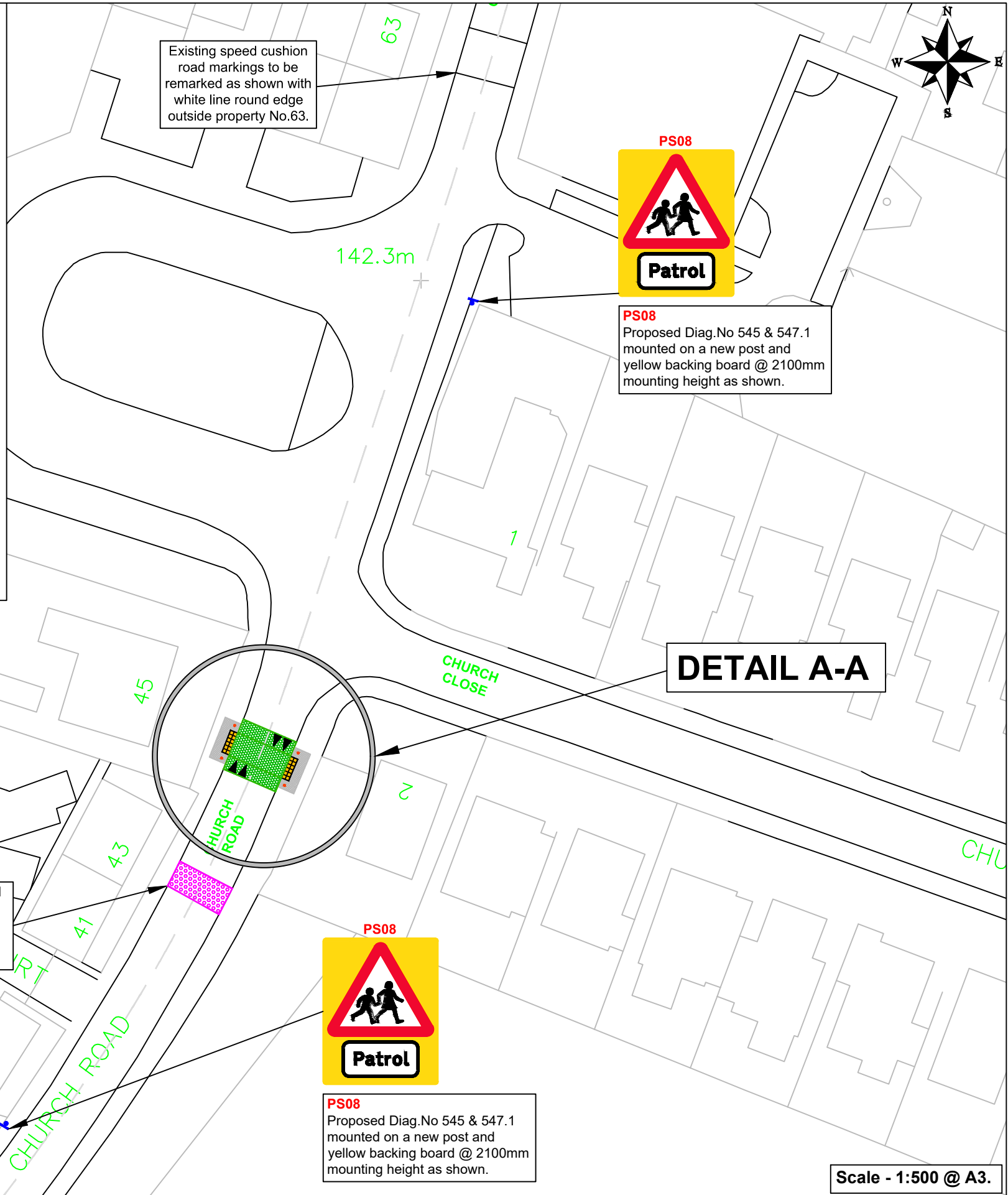

H:\CH-Minor Works\DELEGATED BUDGETS\N.Works District\DB5005 Bell\PTR022 033 Castle Road Hartshill Traffic Calming Scheme\5 Drawings\PTR022 033 01 - Castle Hill Hartshill - Traffic Calming Scheme.dwg

County Highways Minor Works
Warwickshire County Council
Shire Hall
Warwick
CV34 4RL
Tel: 01926 410410

www.warwickshire.gov.uk
chminorworks@warwickshire.gov.uk

NOTES

Based on Ordnance Survey mapping with the permission of the Controller of HMSO
© Crown Copyright and database right 2011. Ordnance Survey 100019520.
All rights reserved.
Unauthorised reproduction infringes copyright and may lead to prosecution or civil proceedings.
Warwickshire County Council.

REV	DATE	BY	CHK	AMENDMENT
-	--/--	-	-	-
-	--/--	-	-	-
-	--/--	-	-	-
-	--/--	-	-	-
-	--/--	-	-	-

Drawing title
Church Rd/Castle Rd/Atherstone Rd, Hartshill - Traffic Calming GA Plan - Sheet 4 of 5 WARWICKSHIRE

Project title
DELEGATED BUDGETS

Drawn by CR	Checked by GS
Date April 2023	
Scale As shown @ A3	
Drawing number PTRO22/033/05	