

It is proposed to introduce footway parking in the locations shown

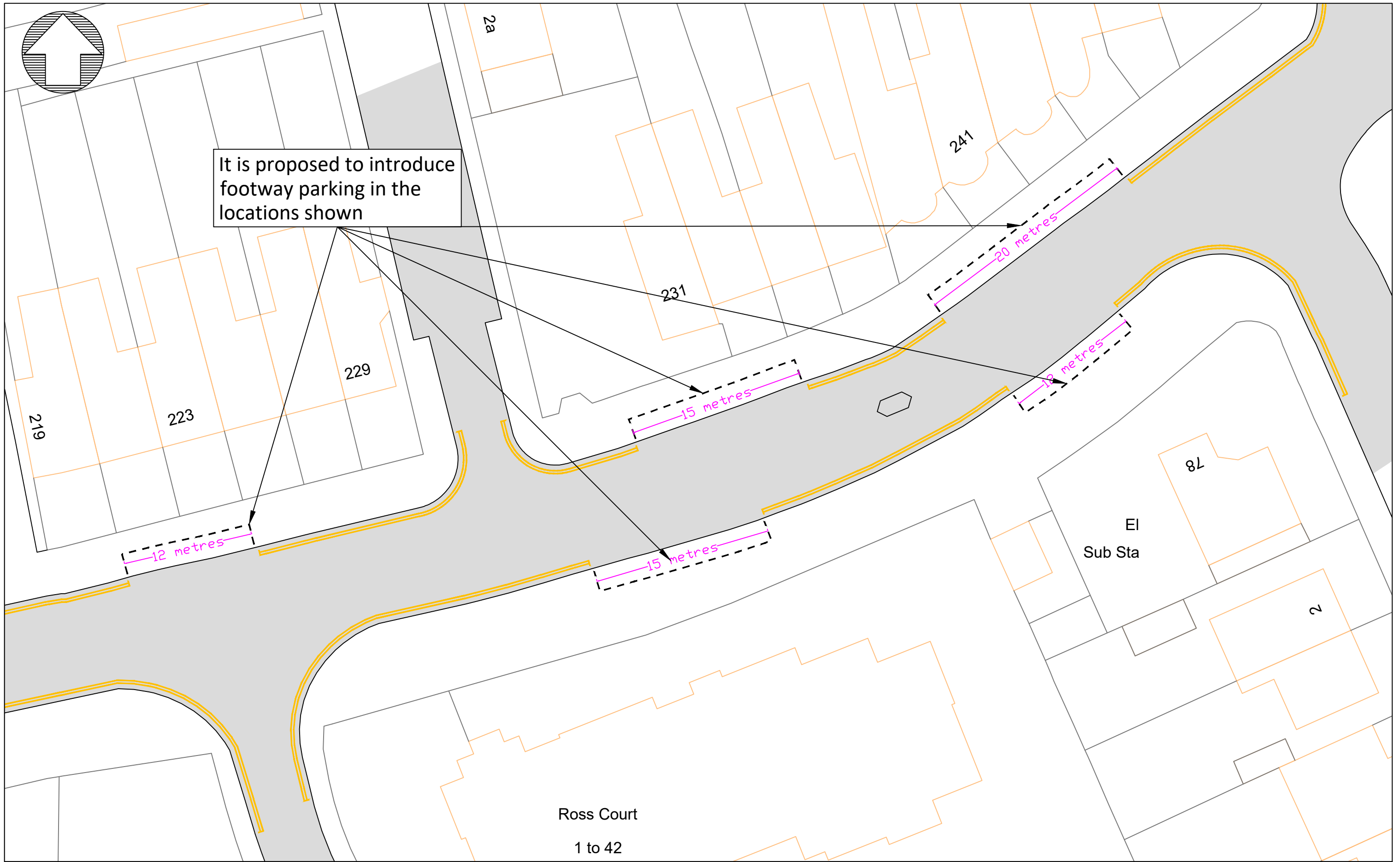

H:\CH-Minor Works\TRAFFIC REGULATION ORDERS\CPE PARKING\Rugby\Variation 8 - Annual programme 23-24\Rugby Informal Consultations.dwg

NOTES

Based on Ordnance Survey mapping with the permission of the Controller of HMSO
 © Crown Copyright and database right 2011. Ordnance Survey 100019520.
 All rights reserved.
 Unauthorised reproduction infringes copyright and may lead to prosecution or civil proceedings.
 Warwickshire County Council.

REV	DATE	BY	CHK	AMENDMENT
-	--/--	-	-	-
-	--/--	-	-	-
-	--/--	-	-	-
-	--/--	-	-	-
-	--/--	-	-	-

Drawing title
Clifton Road Rugby
Proposed Footway Parking
 Project title
Informal Consultations - Rugby

Drawn by BD	Checked by GS
Date 15 October 2023	
Scale NTS @ A3_L	
Drawing number PTRO23-018-001	



County Highways Minor Works
 Warwickshire County Council
 Shire Hall
 Warwick
 CV34 4RL
 Tel: 01926 410410

www.warwickshire.gov.uk
chminorworks@warwickshire.gov.uk