

Limited Waiting bays with a 2 hour restriction are proposed to be installed in the positions shown

Double Yellow Lines are proposed to be installed in addition to the Limited Waiting bays

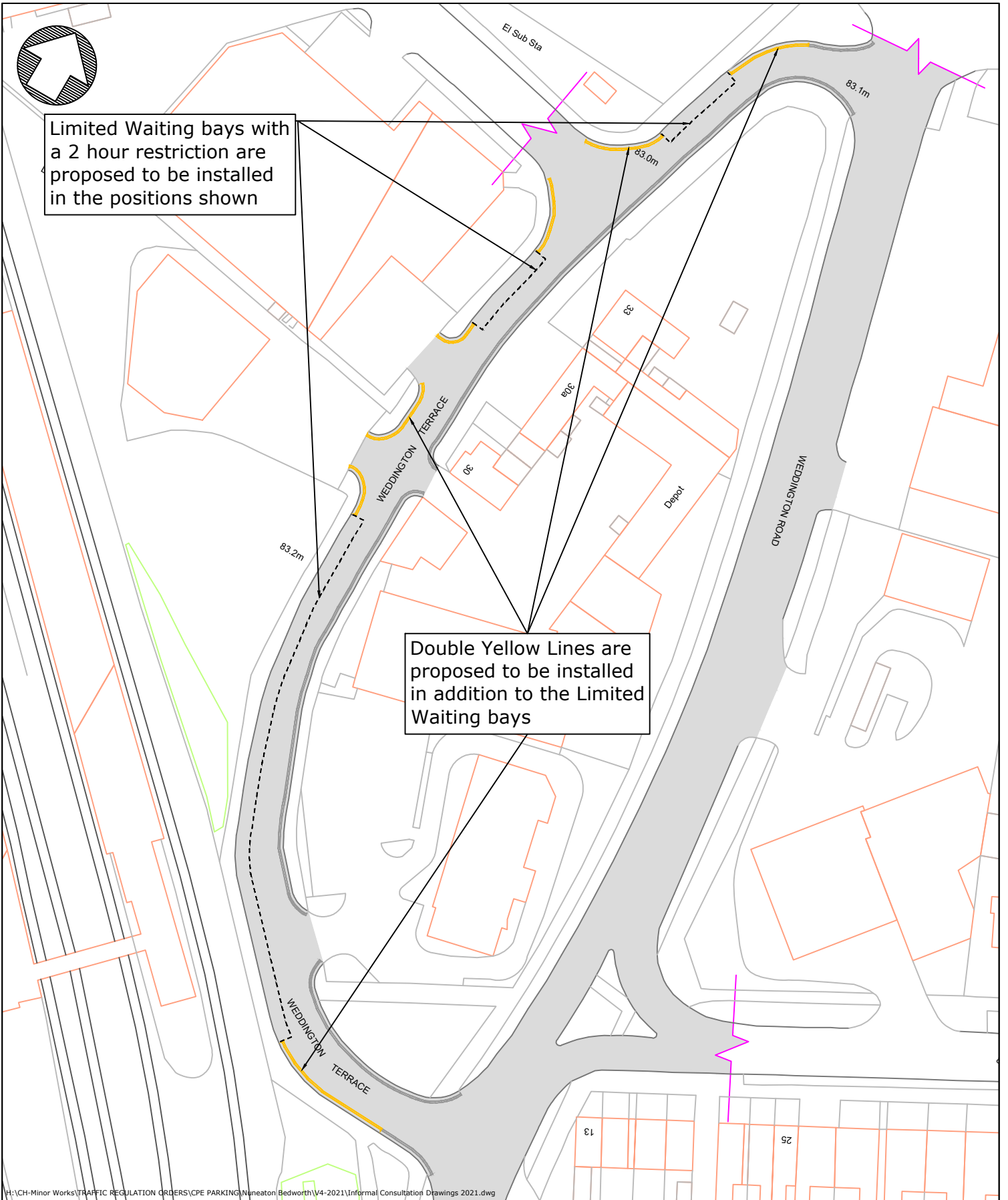

H:\CH-Minor Works\TRAFFIC REGULATION ORDERS\CPE PARKING\Nuneaton Bedworth\14-2021\Informal Consultation Drawings 2021.dwg

REV	DATE	BY	CHK	AMENDMENT	REV	DATE	BY	CHK	AMENDMENT	REV	DATE	BY	CHK	AMENDMENT
-	--/--	-	-	-	-	--/--	-	-	-	-	--/--	-	-	-
-	--/--	-	-	-	-	--/--	-	-	-	-	--/--	-	-	-

NOTES

Based on Ordnance Survey mapping with the permission of the Controller of HMSO.
 © Crown Copyright and database right 2018. Ordnance Survey 100019520.
 All rights reserved.
 Unauthorised reproduction infringes copyright and may lead to prosecution or civil proceedings.
 Warwickshire County Council.

Drawing title
**Weddington Terrace
 Nuneaton
 Limited Waiting and
 Double Yellow Lines**

Project title
Nuneaton and Bedworth CPE Consultation

Drawn by BD	Checked by GVS
Date 18 December 2020	
Scale NTS @ A4P	
Drawing number TR/11270-16	



Traffic & Road Safety
 Communities, Shire Hall Post Room
 Warwick, CV34 4SP
 Tel : 01926 410410

www.warwickshire.gov.uk
mailto:communities@warwickshire.gov.uk