

If this drawing has been printed or converted to pdf format it may no longer be at true scale. It is the recipient's responsibility to confirm its accuracy before use.

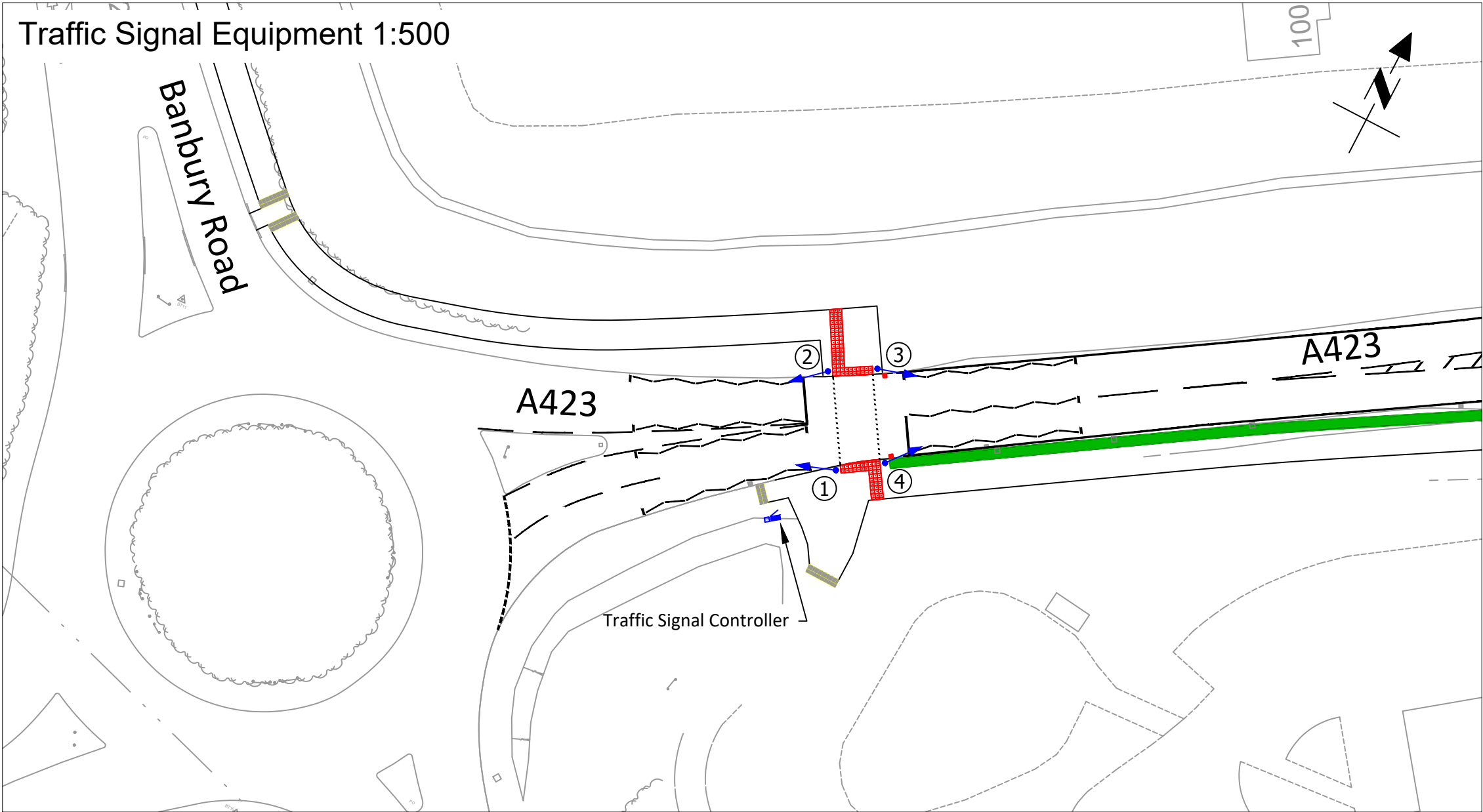

**Key**

	Zig-Zag markings
	Traffic signal equipment mounted on a 3.3m tall traffic signal pole
	Red Tactile Paving
	Traffic Signal Controller (W73cmxD43cmx H116cm) and Feeder Pillar
Existing road markings shown grey	

**Location Plan - Not to Scale**

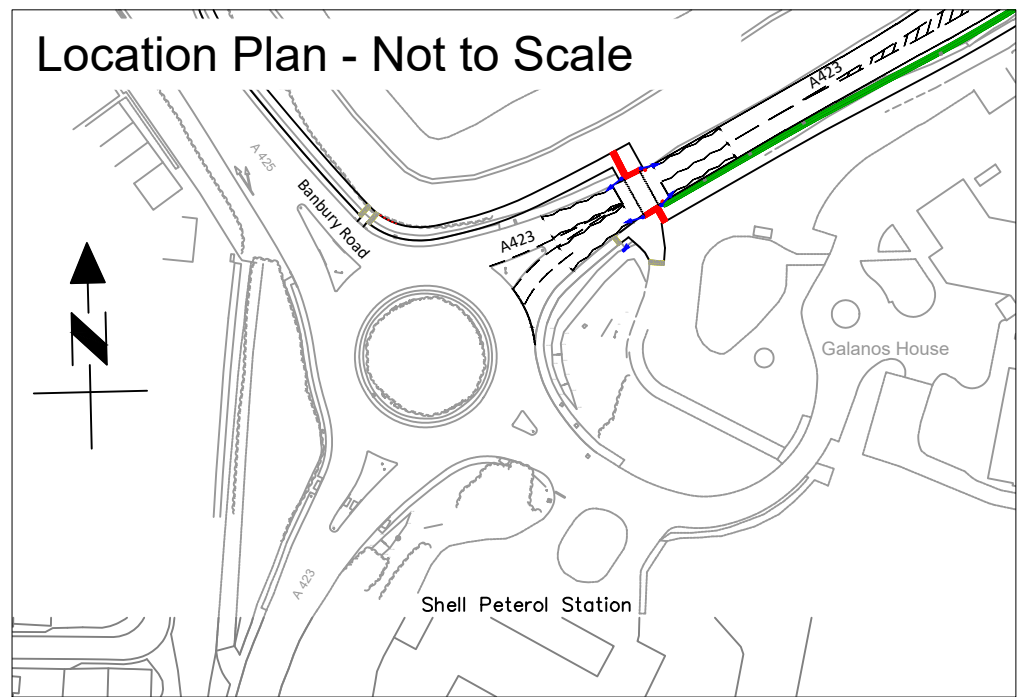

© Crown Copyright and database right  
2025. Ordnance Survey AC000019520.

0mm 50mm 100mm 150mm

REV	DRN	AMENDMENT	DATE

PROJECT PHASE STATUS: CONCEPT DESIGN COMPLETE

**Drawing Content Status:**  
FEASIBILITY WORK IN PROGRESS (ILLUSTRATIVE ONLY)

**Suitable For:**  
CONSULTATION, ROAD SAFETY AUDIT RSA-1A, STATUTORY UNDERTAKER C3  
ESTIMATES, OPTION ASSESSMENT, PROJECT FUNDING BIDS

PROJECT PROGRESS:



**ENGINEERING  
DESIGN SERVICES**

**Engineering Design Services**

Communities Directorate  
Shire Hall  
Warwick  
CV34 4RL  
Tel : 01926 410410  
Web : [www.warwickshire.gov.uk](http://www.warwickshire.gov.uk)



FS 26655

01/07/2025 15:55:25, Lvos, ISO full bleed A3 (420.00 x 297.00 MM)

**PROJECT**

Proposal to Upgrade Existing Puffin to a Toucan Crossing

**TITLE**

Southam Bypass Toucan Crossing - A423 near A425  
Banbury Road  
Consultation Plan

**SCALE**

As Shown

**SIZE**

A3

ORIGINAL BY	LV	REVISION BY	N/A	REVIEWER	GD
DATE	26/06/25	DATE	N/A	APPROVER	GD
PROJECT		ORIGINATOR	VOL./SERIES	LOCATION	
24.2-464	-	WCC	- HSL	-	ZZ
DR	-	TS	- 0002	-	00
TYPE	ROLE	NUMBER	REVISION		

Frame V4.3.2