

DO NOT SCALE

Millimetres

0 10 100

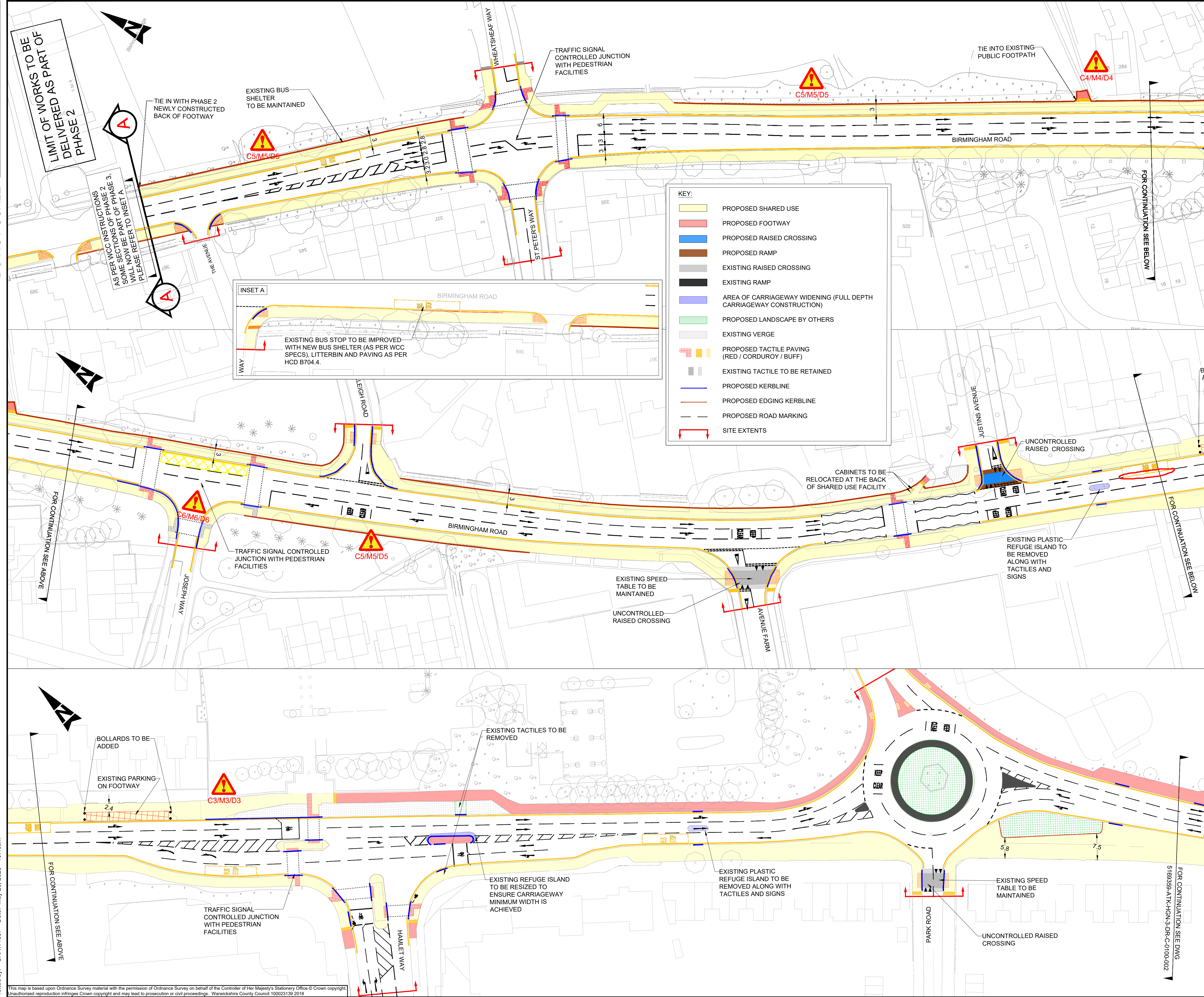

- NOTES:
- THIS DRAWING SHOULD BE READ IN CONJUNCTION WITH ALL ATKINSREALIS ENGINEERING DRAWINGS.
 - THIS DRAWING IS NOT TO BE SCALED.
 - THE CONTRACTOR IS TO VERIFY DIMENSIONS ON SITE AND ADVISE OF ANY INFORMATION DISCREPANCIES. TIE-IN POINTS SHOULD BE VERIFIED ON SITE WITH THE ENGINEER PRIOR TO CONSTRUCTION.
 - ALL WORKS SHALL BE IN ACCORDANCE WITH MCHW SPECIFICATION FOR HIGHWAY WORKS (SHW) AND WARWICKSHIRE COUNTY COUNCIL HIGHWAY CONSTRUCTION DETAILS.
 - REFERENCE TO WCC HCD REFERS TO WARWICKSHIRE COUNTY COUNCIL HIGHWAY CONSTRUCTION DETAIL SHEETS.
 - THE CONTRACTOR IS RESPONSIBLE FOR VERIFYING THE EXACT LOCATION AND EXTENT OF BURIED SERVICES PRIOR TO COMMENCEMENT OF WORKS.
 - SELECTED ROAD MARKINGS OMITTED FOR CLARITY PLEASE REFER TO ROAD MARKING DRAWING 5169359-ATK-HSN-3-DR-C-1200-001/002.
 - FOR CROSS SECTIONAL INFORMATION AND LEVELS REFER TO 3D MODEL 5169359-ATK-HML-XX-M3-CH-0001.
 - ALL OVERGROWN HEDGES OF PRIVATE PROPERTIES TO BE CUT BACK TO THEIR BOUNDARIES.
 - ALL NEW KERBS LINES TO TIE INTO EXISTING KERB LINES AND LEVELS.
 - ALL DRIVEWAY LEVELS ARE TO BE MAINTAINED AS PER EXISTING.
 - LANDSCAPING SCOPE IS BY OTHERS AND WCC WILL PROVIDE LANDSCAPE DETAILS.

SAFETY, HEALTH AND ENVIRONMENTAL INFORMATION

In addition to the hazards/risks normally associated with the types of work detailed on this drawing, note the following significant residual risks (Reference shall also be made to the design hazard log).

- Construction
- C1 - POTENTIAL EXPOSURE TO TAR.
 - C2 - EXISTING BRIDGE STRUCTURE OVER THE WATER CANAL.
 - C3 - EXISTING CULVERT STRUCTURE 2M DEEP.
 - C4 - EXISTING WATER CULVERT STRUCTURE.
 - C5 - TREES WITH TPO.
 - C6 - EXISTING SHALLOW GAS PIPES.
- Maintenance / Cleaning
- AS ABOVE

Use

AS ABOVE

Decommissioning / Demolition

AS ABOVE

Rev.	Date	Description	By	Chk'd	App'd
C07	30/05/2025	REVERT BACK TO EXISTING ROAD MARKING	JF	MA	CT
C06	16/05/2025	REMOVAL OF YELLOW BOXES	JF	MA	CT
C05	25/04/2025	LANDSCAPE AREA AS PER WCC INSTRUCTIONS	JF	MA	CT
C04	10/04/2025	ADDRESSING CLIENT'S COMMENTS.	JF	MA	CT
C03	11/03/2025	ACTIVE TRAVEL COMMENTS	NI	MA	CT
C02	07/02/2025	ADDRESSING CLIENT'S COMMENTS.	NI	MA	CT
P01	05/02/2025	FOR REVIEW	RG	MA	RG

Drawing Status	Suitability
ISSUE FOR CONSTRUCTION	A3

AtkinsRéalis

Two Chamberlin Square
Birmingham
West Midlands
B3 3AX

Tel: +44 (0)1214 835757
Tel: +44 (0)1214 835252
www.AtkinsRealis.com

Copyright © AtkinsRéalis (2025)

Client

Coventry City Council
Metropolitan Borough Council
Warwickshire County Council

WEST MIDLANDS SHARED PROFESSIONAL SERVICES CONTRACT

Project Title

WARWICKSHIRE COUNTY COUNCIL
A3400 BIRMINGHAM ROAD

Drawing Title

GENERAL ARRANGEMENT
SHEET 1 OF 2

Scale	Designed / Drawn	Checked	Approved	Authorised
1:500	JT	MA	RGH	CT
Original Size	Date	Date	Date	Date
A1	27/05/2025	28/05/2025	29/05/2025	30/05/2025
Drawing Number	Project	Originator	Volume	Project Ref. No.
		5169359-ATK-HGN-3-DR-C-0100-001		5169359
Location	Type	Role	Number	Revision
				C07

This map is based upon Ordnance Survey material with the permission of Ordnance Survey on behalf of the Controller of Her Majesty's Stationery Office © Crown copyright. Unauthorised reproduction infringes Crown copyright and may lead to prosecution or civil proceedings. Warwickshire County Council 100023139 2018