

- KEY**
- Proposed low-level planting
  - Proposed kerbline
  - Proposed grey tactile paving
  - Existing tree to be removed
  - Existing tree to remain
  - Proposed tree (subject to underground services)
  - Existing utility cabinets to remain
  - Proposed traffic signal equipment
  - Proposed traffic signal controller cabinet
  - Proposed bollards
  - Proposed street furniture (planters/seating/cycle parking)
  - Proposed shared cycleway /footway
  - Proposed enhanced paving
  - Proposed shared cycleway/footway connection
  - Proposed pedestrian/cyclist crossing on road hump

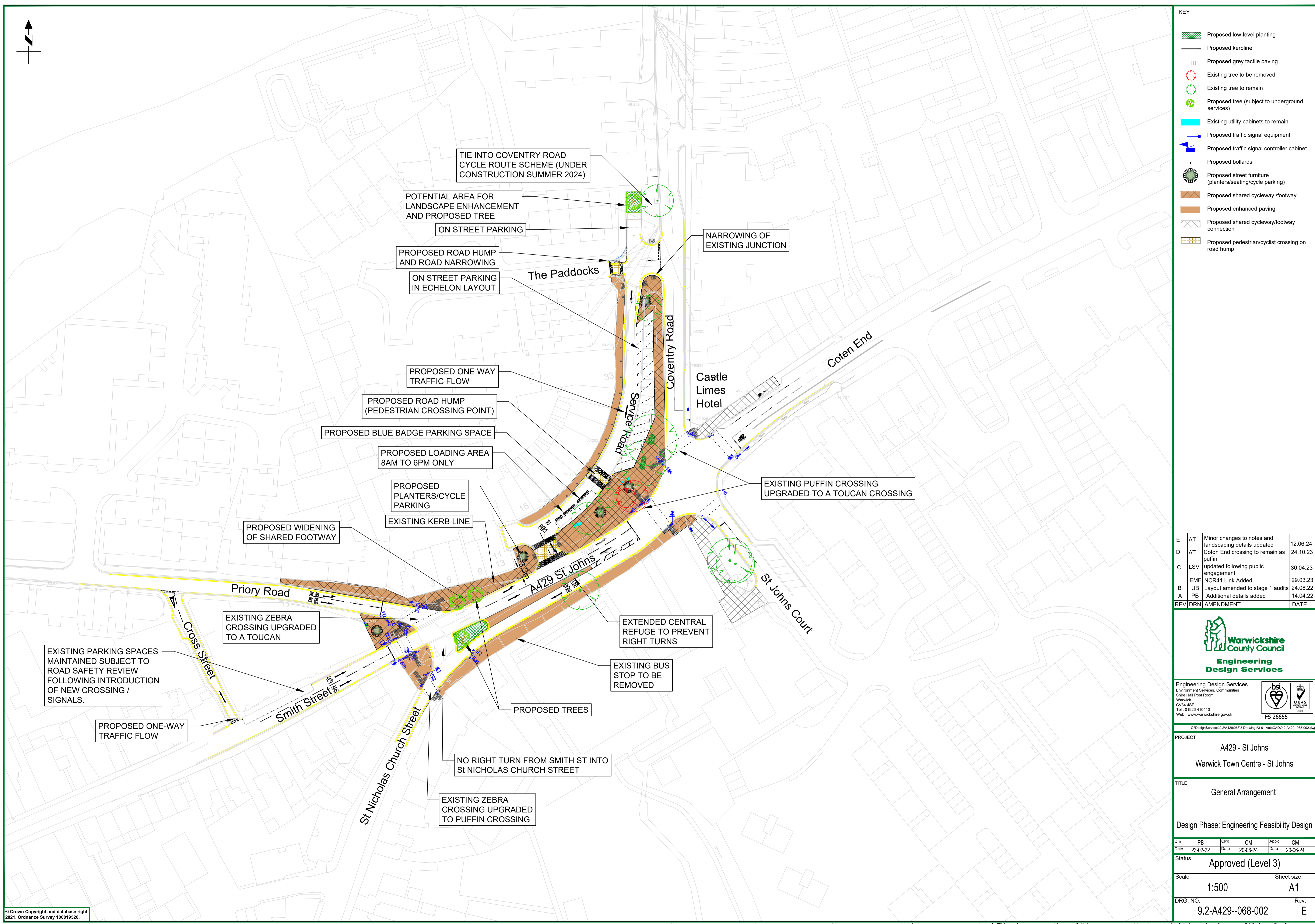

E	AT	Minor changes to notes and landscaping details updated	12.06.24
D	AT	Coten End crossing to remain as puffin	24.10.23
C	LSV	updated following public engagement	30.04.23
	EMF	NCR41 Link Added	29.03.23
B	UB	Layout amended to stage 1 audits	24.08.22
A	PB	Additional details added	14.04.22
REV	DRN	AMENDMENT	DATE



Engineering Design Services  
 Environment Services, Communities  
 Shire Hall Post Room  
 Warwick  
 CV34 4SP  
 Tel : 01926 410410  
 Web : www.warwickshire.gov.uk



PROJECT  
**A429 - St Johns**  
 Warwick Town Centre - St Johns

TITLE  
 General Arrangement

Design Phase: Engineering Feasibility Design

Drn	PB	CKd	CM	App'd	CM
Date	23-02-22	Date	20-06-24	Date	20-06-24

Status **Approved (Level 3)**

Scale **1:500** Sheet size **A1**

DRG. NO. **9.2-A429--068-002** Rev. **E**