

Location Plan - 1:1250

Consultation Plan - 1:500

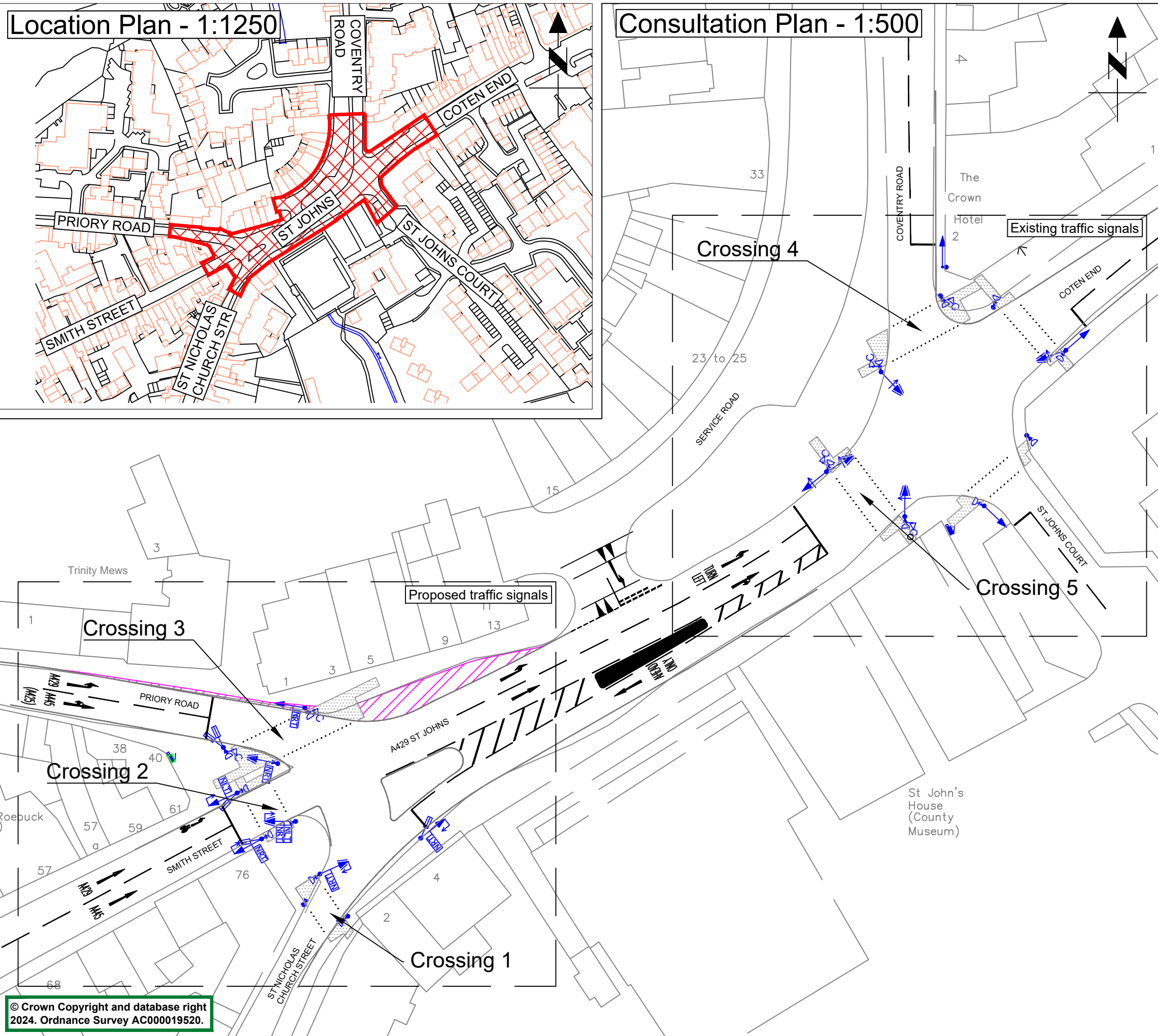

© Crown Copyright and database right 2024. Ordnance Survey AC000019520.

REV	DRN	AMENDMENT	DATE

PROJECT PHASE STATUS: ENGINEERING FEASIBILITY DESIGN COMPLETE

Drawing Content Status:
DELIVERABLE SOLUTION

Suitable For:
DEPARTURES FROM STANDARDS PROCESS, ROAD SAFETY AUDIT RSA-1B, TECHNICAL APPROVAL (SOR & AIP), PROJECT FUNDING BIDS, STATUTORY UNDERTAKER C4 ESTIMATES

PROJECT PROGRESS:



Engineering Design Services

Engineering Design Services
Environment, Planning and Transport
Communities Directorate
Shire Hall
Warwick
CV34 4RL
Tel : 01926 410410
Web : www.warwickshire.gov.uk

PROJECT
Coventry Road /
St Johns / Coten End, Warwick

TITLE
TRAFFIC SIGNAL JUNCTION
ROAD TRAFFIC REGULATION ACT 1984
S23 - PUBLIC CONSULTATION

Drm	MS	Ck'd	CM	App'd	GD
Date	26-02-24	Date	13-03-24	Date	13-03-24

Status
APPROVED (Level 3)

Scale
as shown

Sheet size
A3

DRG. NO.
9.2/A429/068/034

Rev.
-